

TOTAL APPROX. FLOOR AREA 46.5 SQ.M. (501 SQ.FT.)

Whilst every attempt has been made to ensure the accuracy of the floor plan contained here, measurements of doors, windows, rooms and any other items are approximate and no responsibility is taken for any error, omission, or mis-statement. This plan is for illustrative purposes only and should be used as such by any prospective purchaser. The services, systems and appliances shown have not been tested and no guarantee as to their operability or efficiency can be given

Made with Metropix ©2021

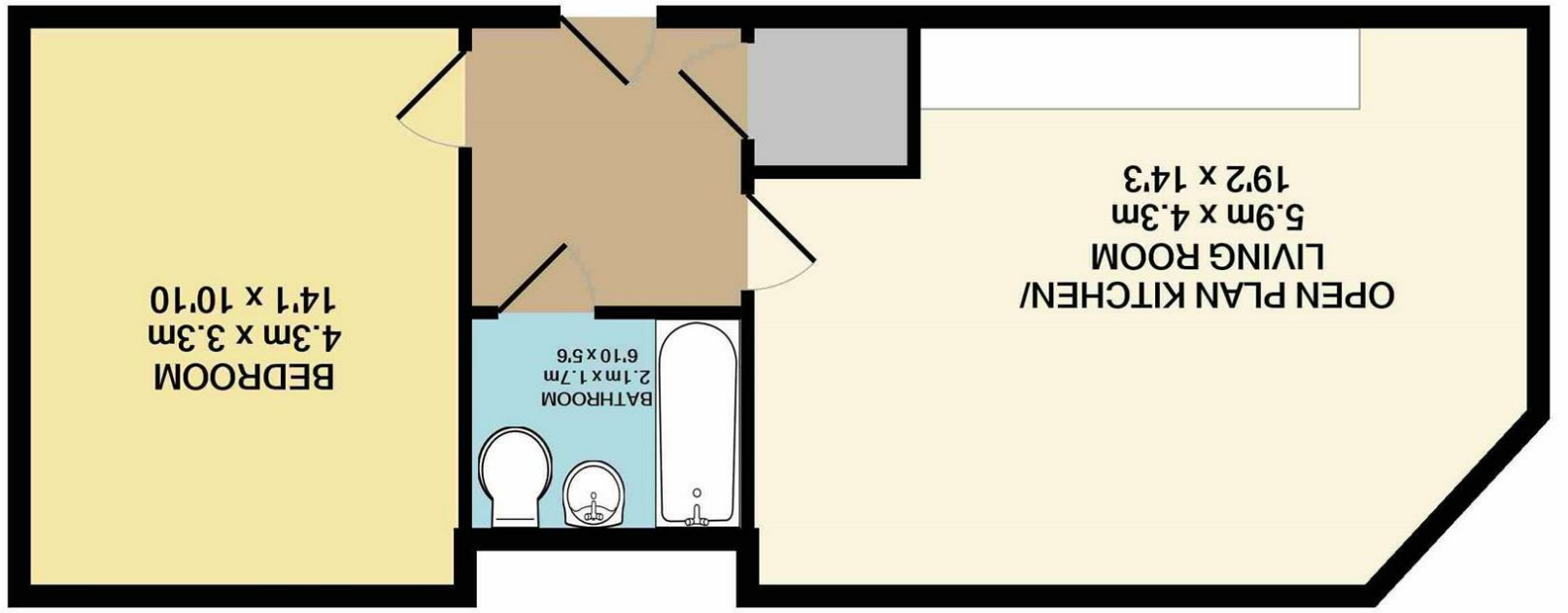

Disclaimer – In accordance with the Property Misdescriptions Act, the company gives notice that all descriptions, references to condition, necessary permissions for use and other details are given in good faith and believed to be correct, but any intending lessees do not rely on them as statements of fact, but must satisfy themselves by inspection or other means, as to their accuracy.

England & Wales	
EU Directive 2002/91/EC	
Very energy efficient - lower running costs	(92 plus) A
	(81-91) B
	(69-80) C
	(55-68) D
	(39-54) E
	(21-38) F
Not energy efficient - higher running costs	(1-20) G
Current	61
Potential	61

Energy Efficiency Rating



Ber Street | Norwich | NR1  
Guide £160,000



abbotFox presents this stylish modern apartment. Located within the desirable Skipper House development, this home affords a convenience hard to match with a variety of local amenities on the doorstep. With accommodation comprising of generous open plan living accommodation, double bedroom and stylish bathroom, this home is an ideal opportunity for any first-time buyer or buy-to-let investor. An internal viewing comes highly recommended.

